

Sd = 1500 mm

- potentiometer
- increased sensing range



general data

sensing range sd	200 ... 1500 mm
scanning range far limit Sde	200 ... 1500 mm
hysteresis typ.	4% Sde
repeatability	< 1 mm
temperature drift	< 0,18% Sde/K
adjustment	potentiometer
response time ton	< 100 ms
release time toff	< 100 ms
alignment aid	target display flashing
sonic frequency	200 kHz
output indicator	LED green

electrical data

voltage supply range +Vs	12 ... 30 VDC
current consumption max.	30 mA
output current	< 200 mA
voltage drop Vd	< 2 VDC
residual ripple	< 10% Vs
short circuit protection	yes
reverse polarity protection	yes

mechanical data

type	cylindrical
housing material	brass nickel plated
width / diameter	30 mm
height / length	70 mm

ambient conditions

operating temperature	-25 ... +60 °C
protection class	IP 67

accessories

connectors	ES 14, ESW 33A, ESG 34A
------------	-------------------------

dimension drawings

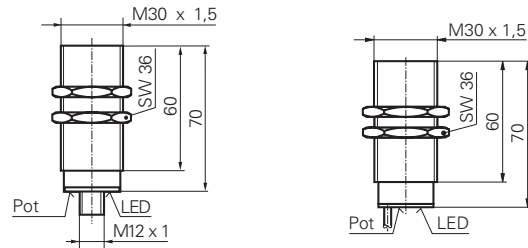

connection diagrams

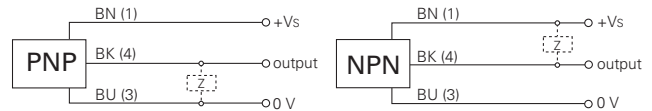

typical sonic cone profile

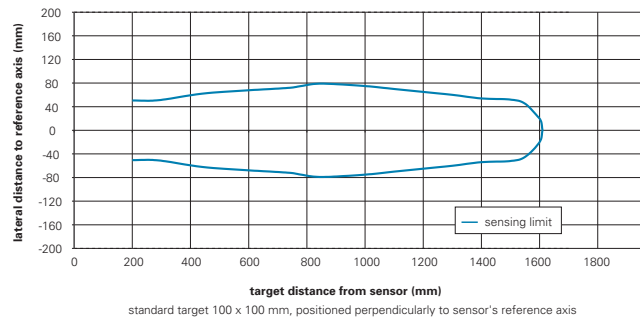

UNAM 30 Sd = 1500 mm

Ultrasonic proximity sensors

order reference	output circuit	connection types
UNAM 30N1104	NPN make function (NO)	cable
UNAM 30N1104/S14	NPN make function (NO)	connector M12
UNAM 30N3104	NPN break function (NC)	cable
UNAM 30N3104/S14	NPN break function (NC)	connector M12
UNAM 30P1104	PNP make function (NO)	cable
UNAM 30P1104/S14	PNP make function (NO)	connector M12
UNAM 30P3104	PNP break function (NC)	cable
UNAM 30P3104/S14	PNP break function (NC)	connector M12

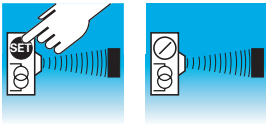

Sd = 1000 mm

- Teach-in or potentiometer
- 0 ... 10 V / 4 ... 20 mA
- signals of Teach-in version invertible



general data

sensing range sd	100 ... 1000 mm
scanning range far limit Sde	100 ... 1000 mm
repeatability	< 0,5 mm
resolution	< 0,3 mm
sonic frequency	240 kHz
response time ton	< 80 ms
release time toff	< 80 ms
alignment aid	target display flashing
temperature drift	< 2% of distance to target So

potentiometer

light indicator	LED green
-----------------	-----------

Teach-in

scanning range close limit Sdc	100 ... 1000 mm
light indicator	yellow LED / red LED

electrical data

voltage supply range +Vs	15 ... 30 VDC
output current	< 20 mA
residual ripple	< 10% Vs
short circuit protection	yes
reverse polarity protection	yes

voltage output

current consumption max.	35 mA
--------------------------	-------

current output

current consumption max.	55 mA
load resistance +Vs max.	< 1100 Ohm
load resistance +Vs min.	< 400 Ohm

mechanical data

type	cylindrical
housing material	brass nickel plated
width / diameter	30 mm
height / length	70 mm

ambient conditions

operating temperature	-10 ... +60 °C
protection class	IP 67

accessories

connectors	ESW 33S, ESG 34S
------------	------------------

dimension drawings

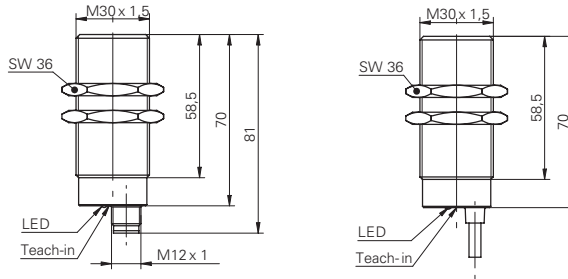

Teach-in = Teach-in or potentiometer

connection diagram

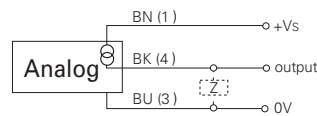

typical sonic cone profile

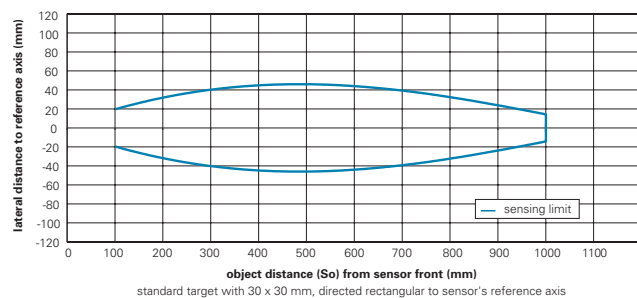

UNAM 30 Sd = 1000 mm

Ultrasonic analog sensors

order reference	version	adjustment	output circuit	output signal	connection types
UNAM 30I6103	standard	Teach-in	current output	4 ... 20 mA / 20 ... 4 mA	cable
UNAM 30I6103/S14	standard	Teach-in	current output	4 ... 20 mA / 20 ... 4 mA	connector M12
UNAM 30I6803/S14	multiplex version	Teach-in	current output	4 ... 20 mA / 20 ... 4 mA	connector M12
UNAM 30U6103	standard	Teach-in	voltage output	0 ... 10 V / 10 ... 0 V	cable
UNAM 30U6103/S14	standard	Teach-in	voltage output	0 ... 10 V / 10 ... 0 V	connector M12
UNAM 30U9103	standard	potentiometer	voltage output	0 ... 10 VDC	cable
UNAM 30U9103/S14	standard	potentiometer	voltage output	0 ... 10 VDC	connector M12